

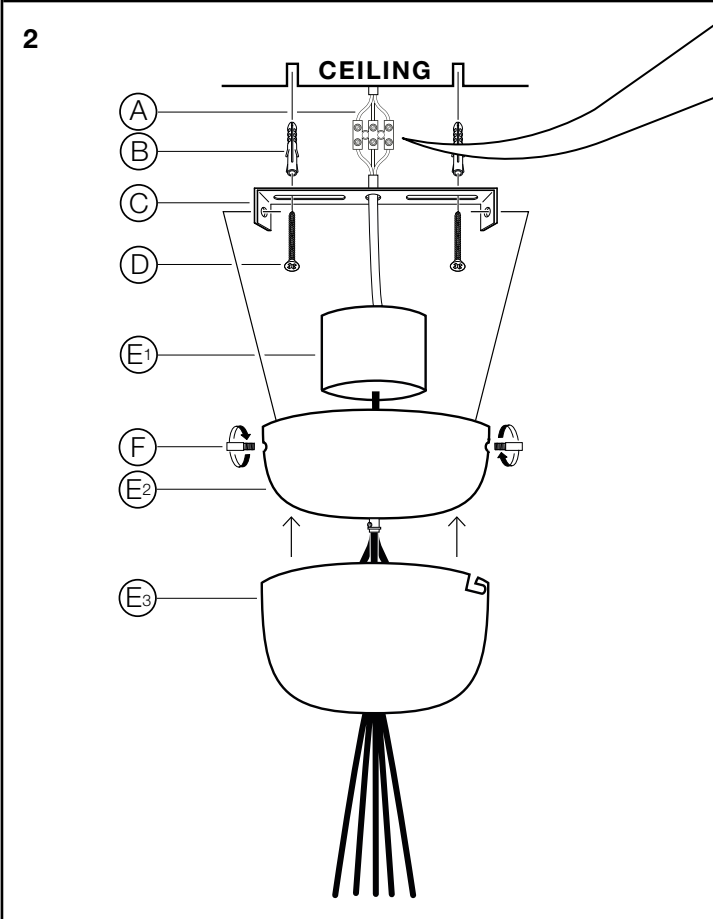

E I C H H O L T Z

108837 LAMP POLYGON

ASSEMBLY INSTRUCTION

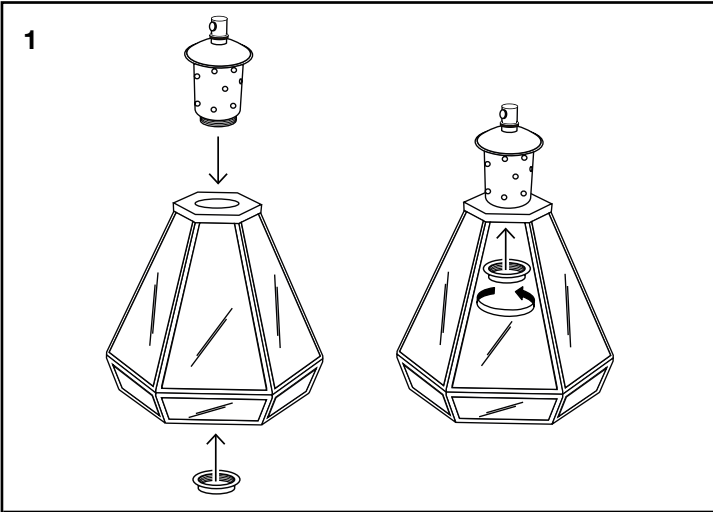

Connect the two power wires coming out from the ceiling to the Lustrer Terminal (A)."

After connecting the two wires, secure the mounting plate (C) with screw (D) in to wall plug (B).

Tighten the canopy (E) with the side screw (F) to the mounting plate (C) and tighten the screw on plastic cord grip (G).

Secure the Light Bulb (H) / E27 into the Plastic Lamp holder (I). To prevent the risk of fire, do not use light bulbs with wattage greater than 40W.

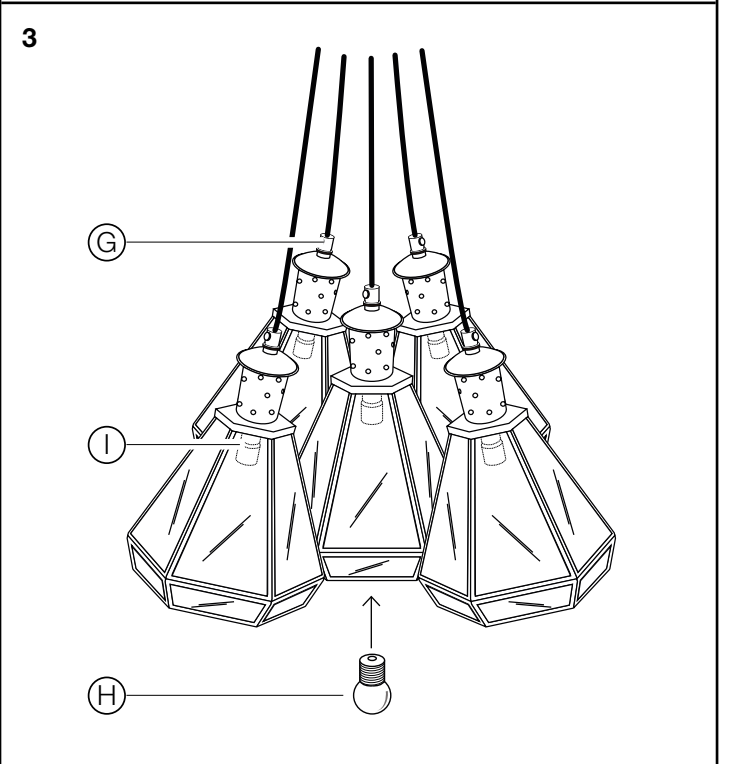
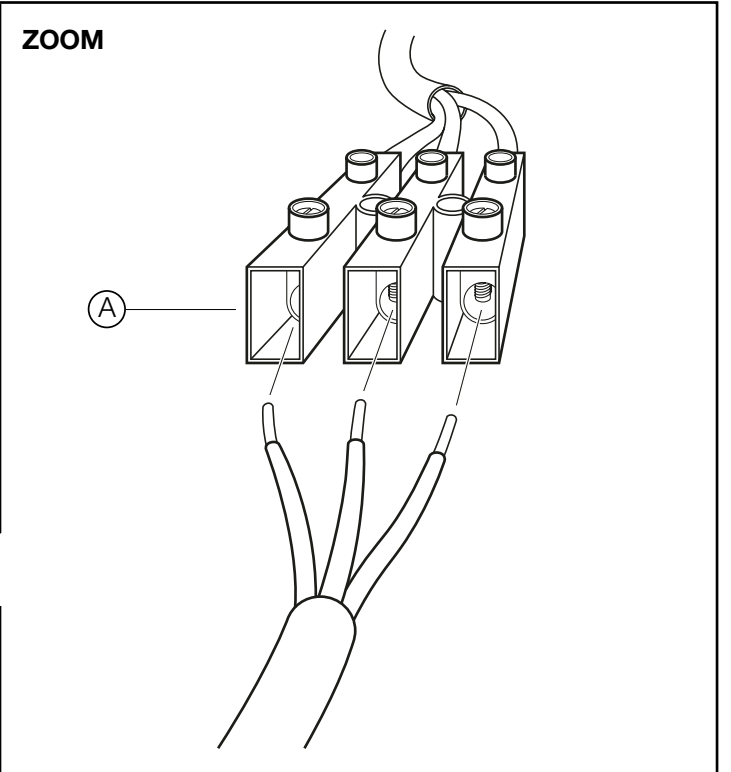

**CARE INSTRUCTION**

Wipe clean with soft, dry cloth.  
Always avoid the use of harsh chemicals or abrasive cleaners as they may cause damage to the fixture's finish.